

Dedicated Open Space  
GOLD CREEK  
THIS AREA TO BE COMMUNITY AREA

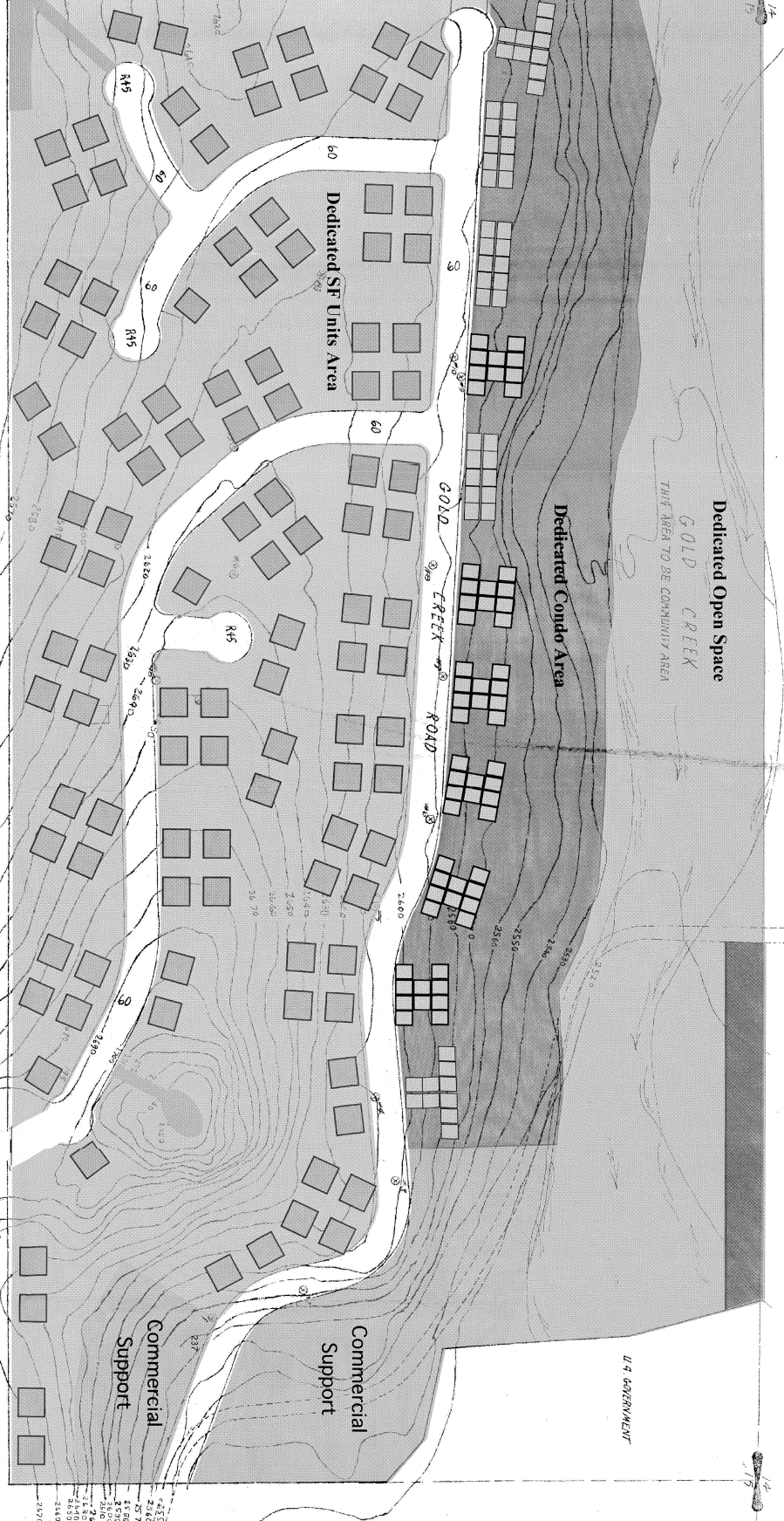

MONTELLI GRANDELLI INC.  
P.O. BOX 19170, WELLSBORO VT.  
45401E, Vt. 05707

# SNOCADIA ON GOLD CREEK



DATE	DESCRIPTION
MARCH 15, 1978	ORIGINAL SUBMITTAL DATE FOR BASE MAP
MARCH 15, 1978	ORIGINAL SUB DIVISION PLAN SUBMITTED ON NOVEMBER 14, 2007
SCALE	1" = 100'
LEGAL DESCRIPTION	E/2 NE 1/4 OF SECTION 15, TOWNSHIP 22 NORTH, RANGE II EAST, W. M., KITTITAS COUNTY, WASHINGTON #23-11-15010-0001 (R037855), #22-11-15010-0006 (R037856), #22-11-15010-0008 (R037858), #22-11-15010-0009 (R037859)
TAX PARCELS	121 CONDO FOOT PRINTS, 112 SF BUILDING ENVELOPES
NUMBER OF LOTS	5 COMMERCIAL - LODGING ZONED LOTS
SEWAGE SYSTEM	SNOCADIA/AMMIE PUBLIC UTILITY DISTRICT
WATER SYSTEM	SNOCADIA/AMMIE PUBLIC UTILITY DISTRICT
SURVEYOR	JEROLD D. O'HARE - LICENSED LAND SURVEYOR, 69666 P.O. BOX 575, ELLENBURG, WA 98926 - (509) 925-4329
LAND MANAGER	MICHAEL L. DARLAND
DEVELOPER/OWNER	MICHAEL L. DARLAND 2021 102nd St. SE BELLEVUE, WA
ROAD SYSTEM	TO BE DEDICATED TO THE PUBLIC-ALL ROADS TO BE TO DESIGNED AND CONSTRUCTED TO COUNTY ROAD STANDARDS



904, 1202 511E